



BIOCLIMATIC PERGOLAS

PALMIYE

MADE FOR OUTDOOR LIFE



1 MANIFESTO

2 BIOCLIMATIC PERGOLAS

6 MODELS

8 Skyroof Prestige (Retractable Bioclimatic Pergolas)

20 Skyroof Plus (Rotatable Bioclimatic Pergolas)

30 Skyroof Fixed (Fixed Bioclimatic Pergola)

36 TECHNICAL SPECIFICATIONS



**MADE FOR
OUTDOOR LIFE**



At Palmiye, we believe in enhancing people's lives through innovative outdoor solutions, making daily life easier and better. For over 25 years, we have been building innovative systems which are at the crossroads of art and science. Engineering and creativity. Global knowledge and client focus. Craft, quality, freedom of choice, and custom-made solutions that are sustainable. We do this in ways that endure and stand the test of time. Reflecting our commitment to creating a lifestyle

Made For Outdoor Life.

BIOCLIMATIC PERGOLAS

Discover
the wonders of
**BIOCLIMATIC
PERGOLAS.**

Bioclimatic systems are durable and robust structures consisting of aluminum ceiling panels and an aluminum framework.

They are controlled via a motor and remote control, providing protection from the sun and rain, with the ability to withstand snow loads and strong winds. After adding side enclosures, it also allows for climate control.



They can be used year-round in all outdoor spaces, both commercial and residential side, making them suitable for all seasons.

We are transforming outdoor spaces into waterproof areas that can withstand snow loads.

**Enhancing
indoor
environment
efficiently**

MODELS



RETRACTABLE

SKYROOF **PRESTIGE**



ROTATABLE

SKYROOF **PLUS**



FIXED

SKYROOF **FIXED**



SKYROOF PRESTIGE

Retractable
Bioclimatic
Pergolas

SKYROOF PRESTIGE

Modular aluminium pergola system with retractable blades and integrated gutter system.

Whether you want to create a cozy outdoor dining area, a serene garden retreat, or an inviting space for entertaining guests, Skyroof Prestige offer endless possibilities for elevating your outdoor lifestyle.



Experience
the perfect synergy of
modern design
sustainable living
outdoor comfort



Transform your outdoor space into a versatile oasis that adapts to your **every need and allows you to connect with nature in style.**



Elevate your outdoor with **SKYROOF PRESTIGE.**

By gathering the panels on one side as per your preference, it provides a **79% ceiling opening when folded.** This makes it incredibly easy to access the sky with just a single touch.

Our systems are capable of bearing snow loads, resistant to strong winds, and completely waterproof thanks to their built-in gutter and sealing system.

**comfortable
functional
and versatile spaces.**

These adaptable structures are used in various settings, providing year-round usability in both commercial venues like restaurants, cafes, and hotels, as well as in residential gardens.



ALL DAY LONG

Designed for all-day use and offer lighting features. This allows you to adjust the illumination of the space during both day and night, enhancing your atmosphere. **They can be used for both business and leisure purposes and provide ease of use with lighting options.**



CONTROL & AUTOMATION SYSTEM

Skyroof Prestige integrates seamlessly with your home systems, enhancing daily life by allowing effortless control of your outdoor space, whether for relaxation, entertainment, or other purposes. This capability elevates your quality of life.



INSULATED PANELS CLIMATE CONTROL

Skyroof Prestige has adjustable retractable louvers for controlling sunlight and airflow, providing a versatile outdoor space for any weather. Polyurethane foam in the panels enhances comfort and minimizes condensation.



KEEP DRY IN STYLE AND STAY CLEAN

Keep Dry in Style Multi Sealing system-sealed with high quality gasket plugs, providing a completely airtight space which can be used in all weather conditions.

The "Stay Clean" feature, with its unique elliptical design, prevents leaves and dust from entering the interior during panel movement.



TECHNICAL FEATURES

MAKSIMUM DIMENSIONS

Projection	691,3 cm
Width	400 cm
Snow Load (max)	375 kg/m ²
Max. Open Space	%79

OPTIONS

Lighting	Perimeter Lighting
Panels	Insulated
Colour	Dual Colour

PROFILES & SNOW LOAD CAPACITY

Thanks to its strong structure, profile dimensions and unique panel design, Skyroof Prestige can handle a snow load of 375 kg/m² and withstand winds up to 117 km/h.

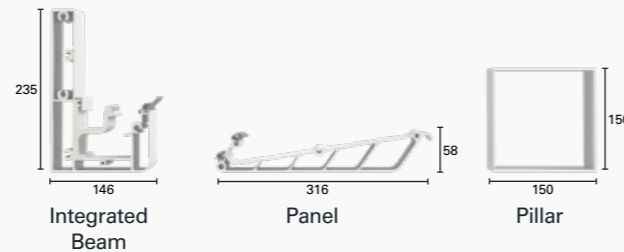

SYNCHRONIZED PANEL MOVEMENT

This special synchronized movement is the newest technological system, allowing simultaneous retraction of all panels.



PANEL INCLINATION

A 8.75% internal inclination on the top of the panels ensures perfect drainage by preventing water accumulation on the system.

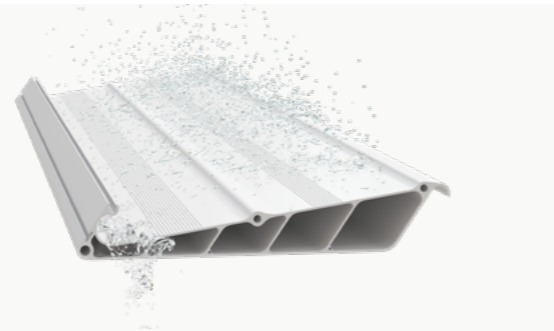

PANEL INTERLOCK

Thanks to the synchronous closing movement of the panels, the gaskets on the panels are clamped together at the same time and a complete insulation is provided between the panels.





SKYROOF PLUS

Rotatable
Bioclimatic
Pergolas

SKYROOF PLUS

Modular aluminium pergola system with rotatable blades and integrated gutter system.

The motorized roof consists of rotatable aluminium panels. Palmiye's revolutionary design allows the panels at any angle up to 120 degrees seamlessly move.

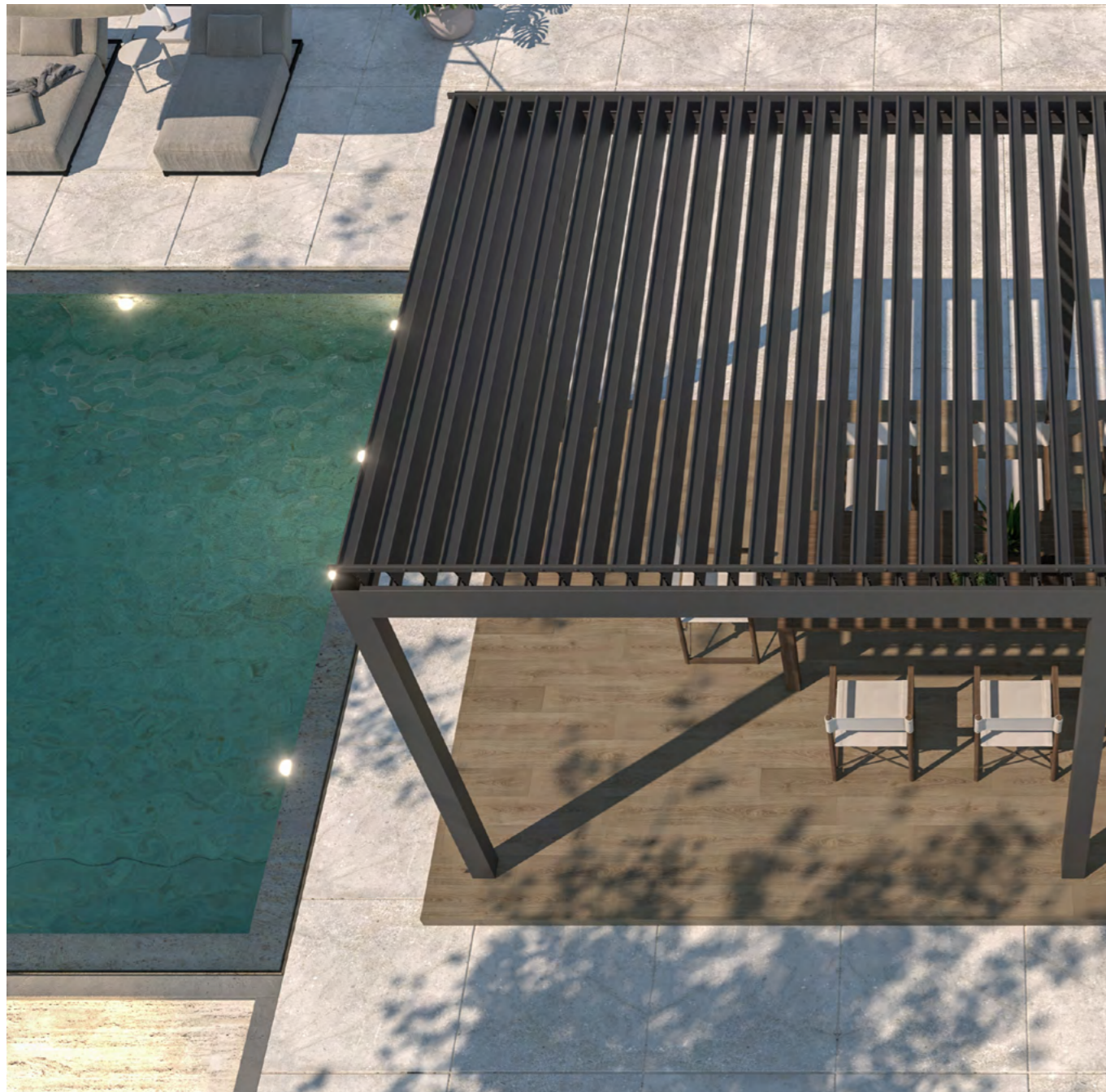

Ultimate Versatility: SKYROOF PLUS - YOUR PERGOLA SOLUTION

Skyroof Plus panels capable of rotating up to 120 degrees on their own axes, constitute a pergola model with a sun-blocking concept. With the help of a remote control, customers can position the panels according to the sun's orientation at their desired location.

It can bear snow load, is wind-resistant, and completely waterproof thanks to the integrated gutter system.



TAILORED TO YOU!

The adaptability and versatility of Skyroof Plus make them suitable for a wide range of outdoor settings, providing comfort, aesthetics, and functionality while allowing users to control their outdoor environment.

APPLICATIONS AND FIELDS OF USE!

Rotatable pergolas are used to enhance outdoor spaces in residential and commercial settings, providing comfortable outdoor dining and lounging areas for hotels, cafes, restaurants, as well as recreational spaces, events.



SIMPLIFY YOUR LIFE

Skyroof Plus features adjustable louvers for personalized sunlight and shade control in any weather. This energy-efficient system not only provides shelter from rain and intense sunlight but also optimizes natural light and ventilation, all while offering year-round outdoor enjoyment with remote control.

INSULATED PANELS CLIMATE CONTROL

Skyroof Plus features adjustable louvers for precise sunlight and airflow control, creating the perfect atmosphere for any weather. Panels can be filled with Polyurethane Foam for added comfort and reduced condensation.



CONTROL & AUTOMATION SYSTEM

Skyroof Plus offers integration with your home systems, providing convenient control and use, making it a harmonious part of your daily life.

HIGH PRESSURE CLOSSURE FUNCTION

Skyroof Plus brings the plane flaps power to life. Its linear actuator system shields your spaces from harsh weather.

DRYNESS, ELEVATED

Utilizing a multi-sealing structure and powered by a linear actuator, this design ensures full waterproofing. The high-quality gasket plugs create an airtight environment, allowing for year-round use in any weather conditions.

leave the mess
outdoor
**STAY CLEAN
INDOOR**

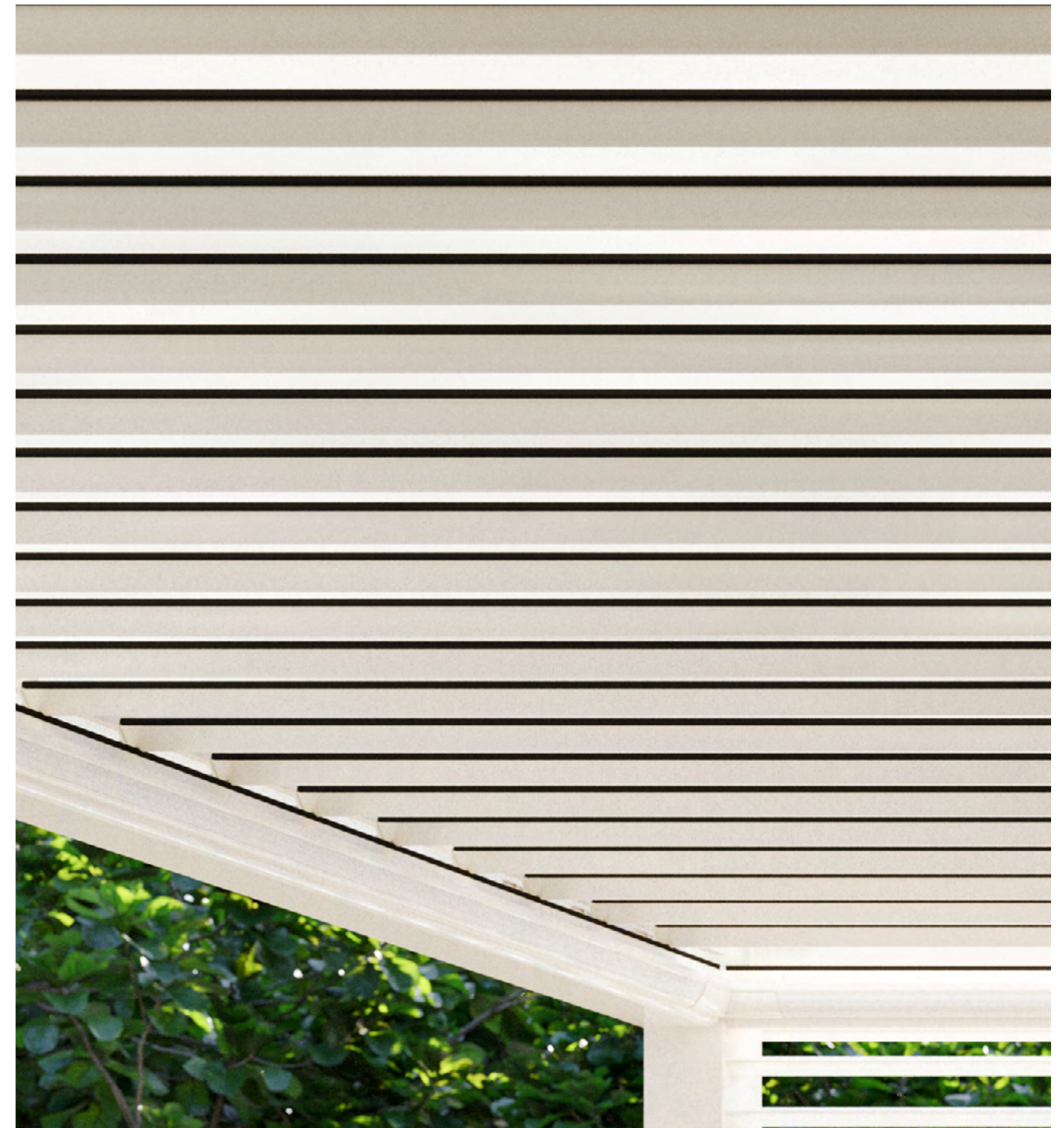

TECHNICAL FEATURES

MAKSIMUM DIMENSIONS

Projection	799 cm
Width	450 cm
Snow Load (max)	336 kg/m ²

OPTIONS

Lighting	Linear Lighting Perimeter Lighting
Panels	Insulated
Colour	Dual Colour

PROFILES & SNOW LOAD CAPACITY

Thanks to its strong structure, profile dimensions and unique panel design, Skyroof Plus can handle a snow load of 336 kg/m² and withstand winds up to 117 km/h.

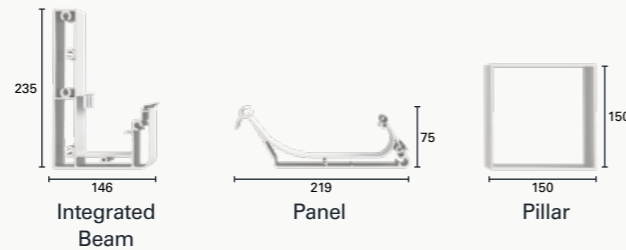

END-POINT-CENTERED ROTATION

This special rotating technology with its distinguished features provides many advantages like integrity, stability and sealing by means of end-point-centered operating structure and high pressured power system.



HIGH PRESSURE CLOSING FUNCTION

Sound of power of the plane flaps come alive with Skyroof. Linear actuator system provides you to isolate your spaces against severe weather.

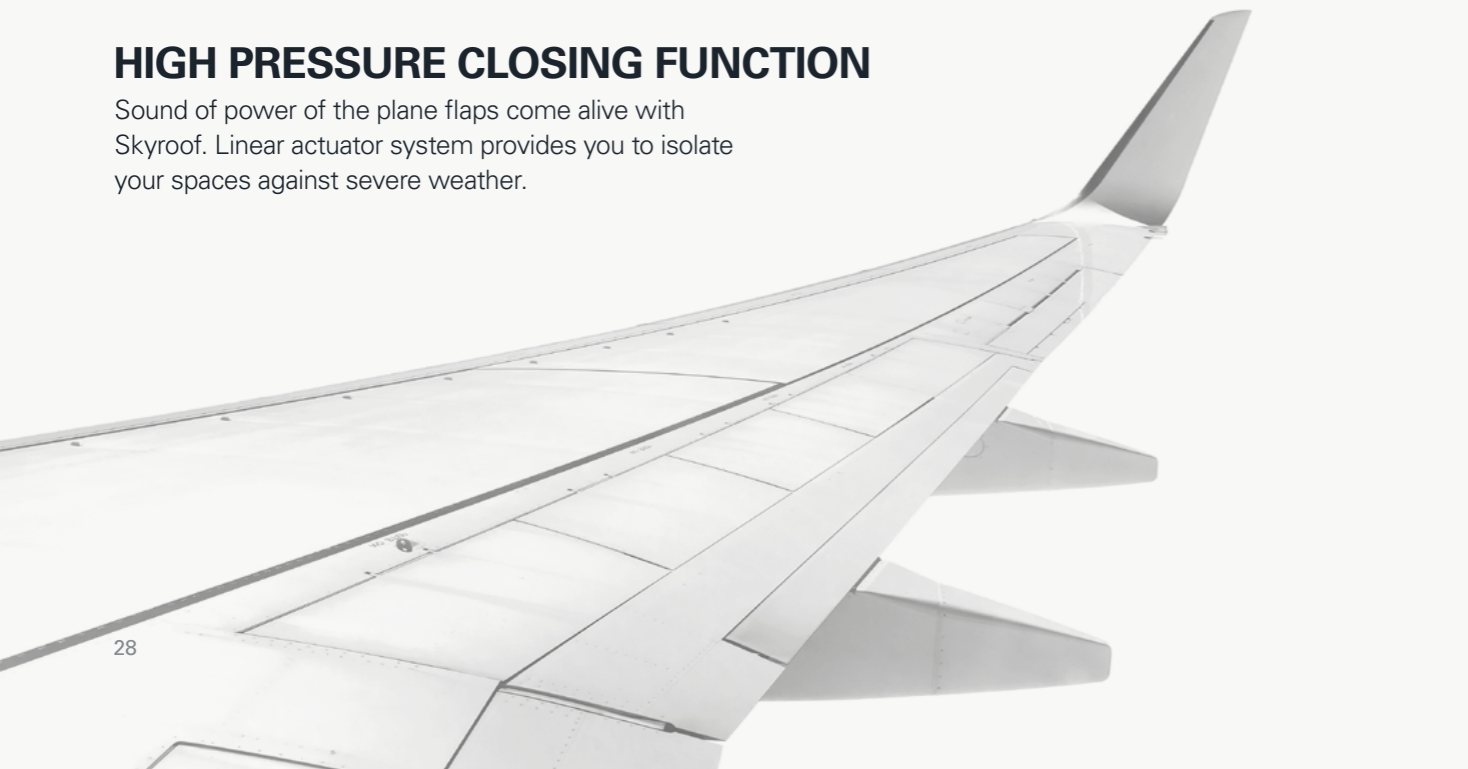

COMPACT VERSION

Created for those who desire minimalism. Thanks to its compact profile design, this option can be preferred for small spaces, offering a delicate structure and appearance.

MAKSIMUM DIMENSIONS

Projection	512,3 cm
Width	350 cm
Snow Load (max)	199 kg/m ²

OPTIONS

Lighting	Perimeter Lighting
Colour	Dual Colour

PROFILES & SNOW LOAD CAPACITY

Thanks to its strong structure, profile dimensions and unique panel design, Skyroof Plus compact can handle a snow load of 199 kg/m² and withstand winds up to 117 km/h.

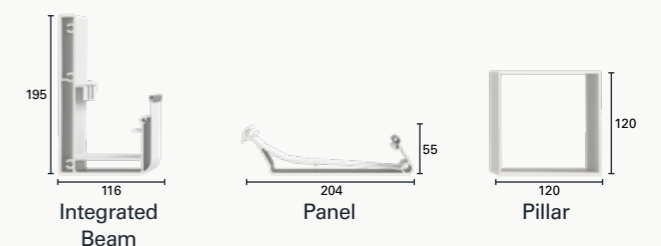



SKYROOF FIXED

Fixed
Bioclimatic
Pergolas

SKYROOF FIXED

A stylish and contemporary shelter for all climates. Whether you're facing scorching heat, driving rain, or even cold winds, this shelter offers both protection and aesthetics, making it the perfect choice for year-round comfort and modern appeal.



Your shelter, your style,
ALL CLIMATES

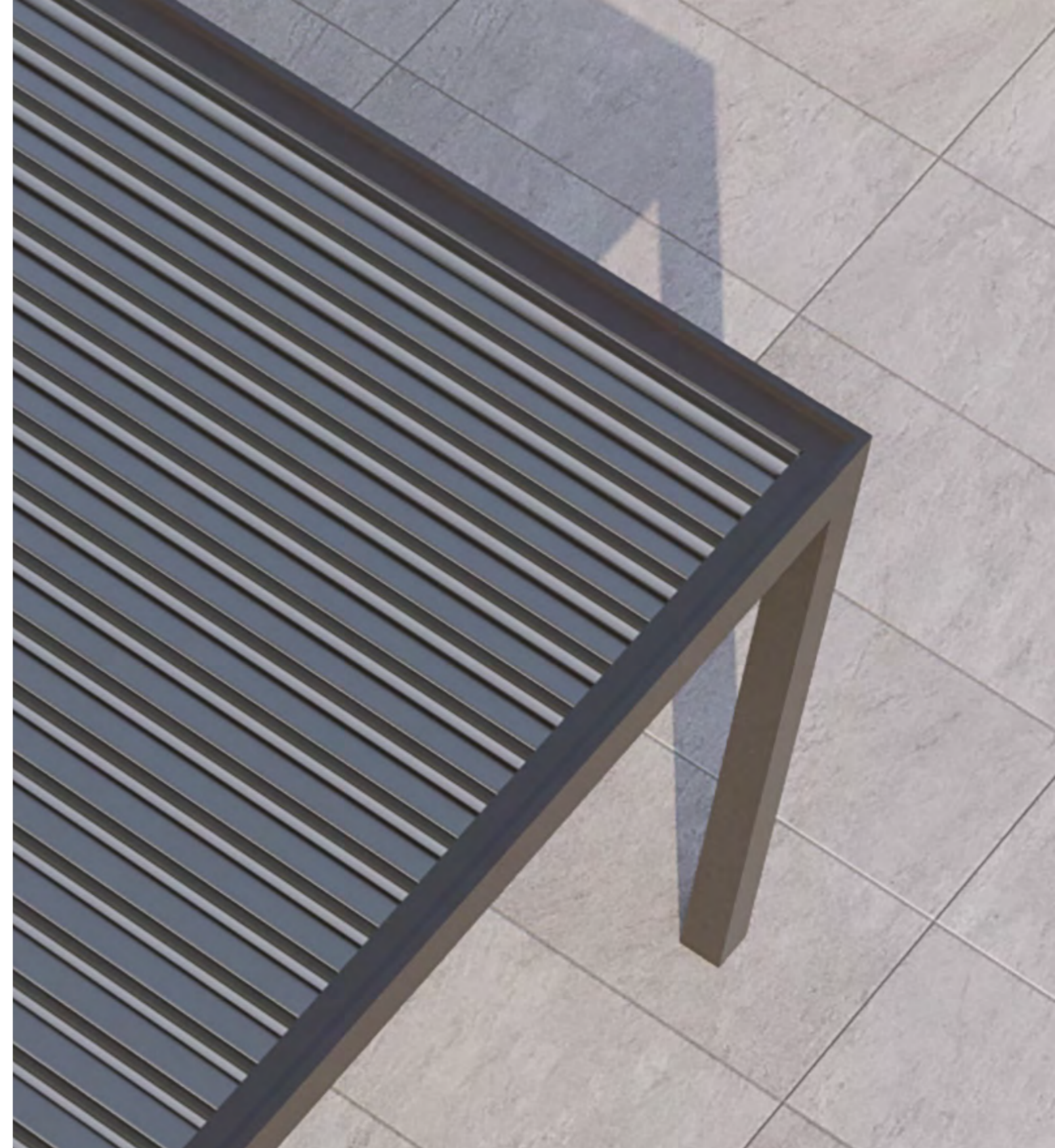

One Solution
**ALL
SPACES**

Skyroof Fixed features seamlessly designed side beams with built-in gutters, corner posts with efficient drainage, robust profiles, and stainless steel attachments for a stable structure. The rubberized slats in the roof create an airtight, waterproof ceiling, and the product can endure winds up to 117 km/h.

Minimal Maintenance,
**MAXIMUM
PROTECTION.**

These structures offer year-round protection from rain, sun, and snow. They regulate indoor temperatures, saving energy. Their modern design enhances outdoor aesthetics, requiring minimal upkeep for practicality. Built to withstand harsh weather, they use durable materials for long-term use.



**TECHNICAL
FEATURES**

MAKSIMUM DIMENSIONS

Projection	588 cm
Width	325 cm
Snow Load (max)	360 kg/m ²

OPTIONS

Lighting	Perimeter Lighting
Panels	Insulated
Colour	Dual Colour

**PROFILES & SNOW
LOAD CAPACITY**

Thanks to its strong structure, profile dimensions and unique panel design, Skyroof Fixed can handle a snow load of 336 kg/m² and withstand winds up to 117 km/h.

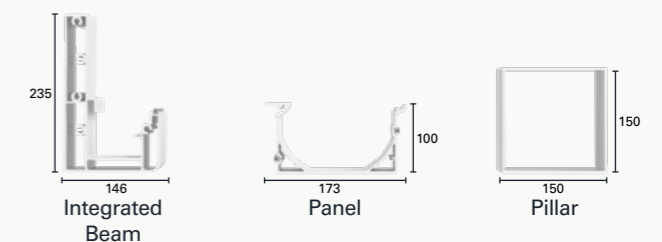



TECHNICAL SPECIFICATION

INSTALLATION TYPES

Skyroof Prestige can be wall-mounted if needed or independently designed to stand on its own posts.



Wall Mounted

Freestanding

MODULARITY

Its modular structure allows for the closure of infinite square meters of space.

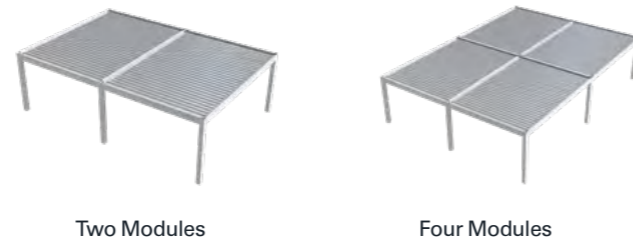

Two Modules

Four Modules

ANCHORAGE & WATER OUTLET

Freestanding products use base plates, while wall-mounted options utilize stainless steel base connections. Hidden anchorage is also available upon request. Models without a water outlet are also available for all options.

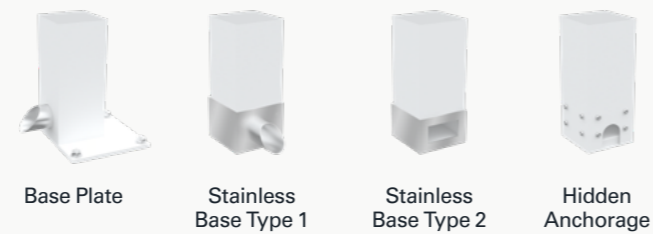

Base Plate

Stainless Base Type 1

Stainless Base Type 2

Hidden Anchorage

STAY CLEAN

The elliptical chamber on top side of the panel prevents the accumulated materials falling into your indoor space during the panel rotation.



MULTI-SEALING SYSTEM

Synchronized moving panels simultaneously presses the gaskets located on the integrated beams and thus ensure maximum insulation during the closing movement.



CLIMATE CONTROL

Panels can be filled with Polyurethane Foam which provides extra comfort. It significantly helps to reduce condensation.



COLOR OPTIONS

The dual color option allows panels and other structural components to be painted in different colors. We coat profiles with electrostatic powder paint using advanced Nanotechnology.



LIGHTING OPTIONS

Perimeter Lighting, which features integrated LED strips into the gutter profile, is available in all Skyroof series. Linear Lighting involves positioning LED modules into the blades and is only available in the Plus series.

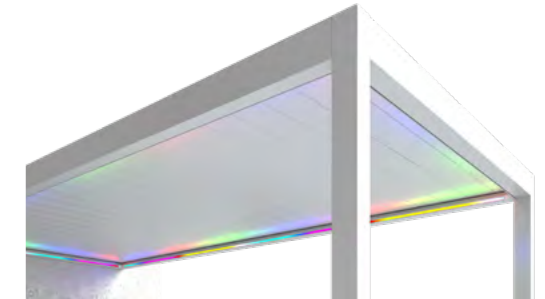

SIDE COVER OPTIONS



Awnings

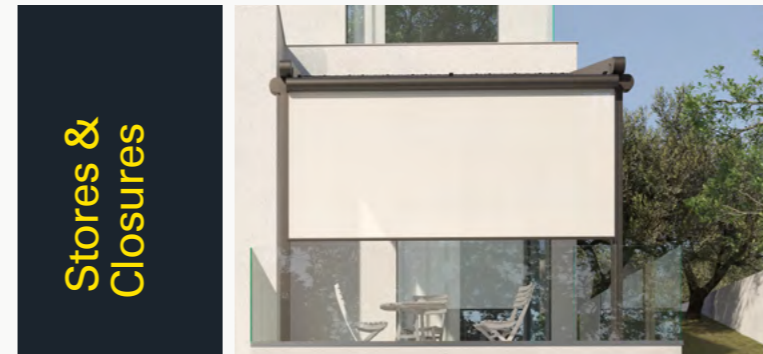

Stores & Closures



Glass Systems



Glass systems, awning systems, side walls such as Aluwall and sun breakers can be applied.

CONTROL & AUTOMATION

Designed to easily control your product wherever you are in the world, despite the weather changes you can remotely activate your products accordingly.

Compatible with iOS and Android smartphone systems. You can assign multiple functions through created scenarios, you can give a one-touch command.



TAILORED TO YOUR LIFESTYLE!

Our products incorporate Somfy motors, remote controls, sensors, and automation systems, giving customers the choice between RTS and IO options.



SITUO 1&5

Elegant design that allows you to easily control your product.

The standard control unit.

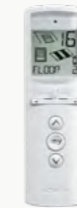

TELIS 16

16 Channel ergonomic design that allows you to control all functions at the same time from one control.

The standard control unit.



SUN SENSOR

It automatically operates product in sunny weather and provides maximum protection from the sun.

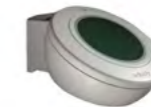

RAIN SENSOR

Enables your product to automatically cover your provides area during maximum rain and protection.



WIND AND SUN SENSOR

By measuring wind speed, it retracts your swing when high speed is detected and provides shade by opening the awning according to the brightness of the sunlight.



WIND SENSOR

It measures the wind speed and automatically retracts your product when high wind speed is detected.

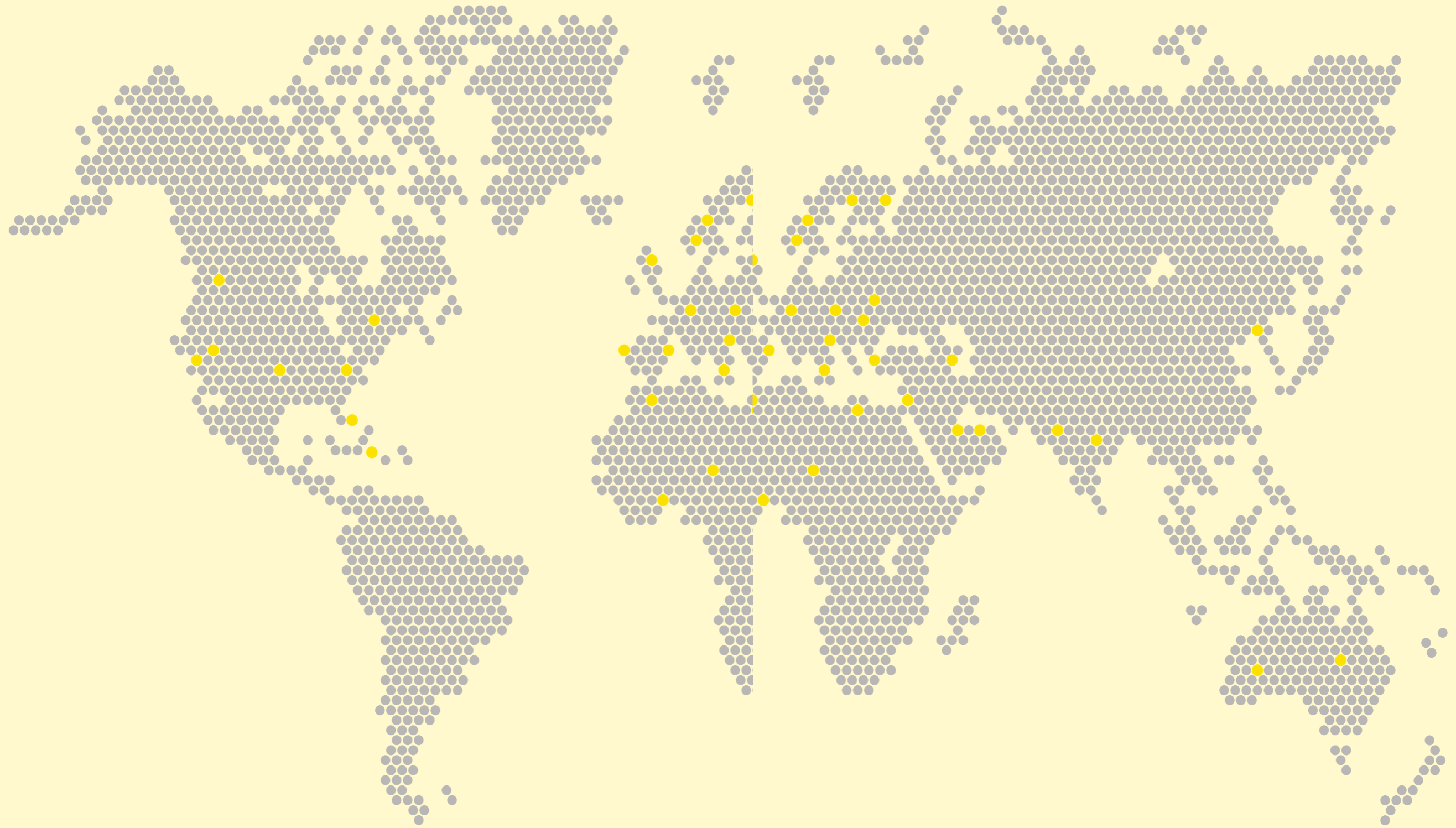

GLOBAL NETWORK

Palmiye is represented in many countries world wide and the values of each and every culture combined with unique architectural concepts, inspires and is reflected in Palmiye' s products.

HEAD OFFICE

World Trade Center IDTM A2 Blok No.77
Yeşilköy 34149 İstanbul – Türkiye
Phone: +90 212 886 7474
info@palmiyeglobal.com

FACTORY

Osmangazi Mah. 2647. Sok. No: 33/1
Esenyurt 34522 İstanbul
Phone: +90 212 886 32 44

